

About Etymotic

Etymotic Research has spent twenty-five years developing in-ear technology for auditory research, precision monitoring and critical listening. Etymotic has developed many innovative hearing technologies available today. Etymotic's products are used by musicians and others who insist on superior sound quality. Etymotic means "true to the ear."

isolator™
earphones

ETYMOTIC RESEARCH INC.
61 Martin Lane • Elk Grove Village, IL 60007
www.etymotic.com • 888-389-6684



©2008. Balancer Earphones is a trademark of Etymotic Research, Inc

ER006318 0310

Filters

Etymotic earphones have special filters that smooth the frequency response and prevent earwax from entering the earphones. A filter is located at the end of the earphone and is visible when the eartip is removed. If a filter becomes clogged, it should be replaced. A dirty filter will reduce earphone output. A filter should be changed if the loudness decreases or the sound quality declines.

Note: Filters are not reusable.

Filter Removal



1. Remove Eartip.

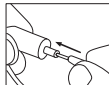

2. Insert tool into the filter.



3. Remove filter.

Filter Replacement



1. Insert a new filter and press gently against a hard surface to secure it in place.



2. Re-attach eartip.

6

Specifications

Frequency response: 50 Hz to 16 kHz
Transducer type : balanced armature
1 kHz sensitivity : 108 dB SPL for a 0.14 V input (105 dB@ 0.1 V; 107 dB @1mW)
Impedance : 16 Ohms
Maximum output: 120 dB SPL
Maximum continuous input: 2.5 Vrms
Weight: less than 1 oz.

Warranty

Etymotic Research, Inc. warrants this product against defects in material or workmanship for a period of one year from the date of original purchase from an authorized Etymotic distributor or reseller.

Etymotic will repair or replace the defective product at its option if returned within the warranty period to our designated service facility. This warranty is in lieu of all other warranties, expressed or implied, including, but not limited to, any implied warranty of merchantability or fitness for a particular purpose.

7

isolator™
earphones



User Manual

ER•6i

Caution

Consult an audiologist or physician if you have excessive ear wax, difficulty inserting the eartips, or discomfort after prolonged use.

Etymotic earphones exclude most external sounds. It is unsafe to use in-ear earphones while operating a motorized vehicle, operating machinery, bicycling or jogging, because you may not be alerted to potential danger.

Do not use the earphones at excessively loud levels. Research confirms that earphones that seal the ear canal allow listeners to choose safer listening levels. Noise-induced hearing loss is a function of exposure time, the average sound level and the peak of very loud sounds. Sealed eartips and lower listening levels allow for longer periods of safe listening time.

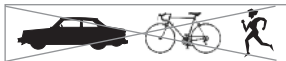

Best Performance

A full bass response depends on proper earphone insertion. For best results, earphones must seal in the ear canals.

2

Included

6i Isolator earphones
5 ft. cord with 3.5 mm stereo plug
Assorted flanged and foam eartips
2 replacement filters
Filter changing tool
Shirt clip
Pouch



3

Earphone Insertion

Flanged eartip insertion

- To ease insertion, moisten the flanged eartips.
- Carefully insert one earphone at a time while pulling up and out on the back of the ear.
- Earphones should seal comfortably in the ear canals.

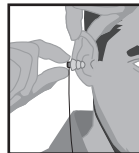

For a video on proper earphone insertion go to www.etymotic.com.

Foam eartip insertion

- Use a foam eartip if a good seal cannot be obtained with a flanged eartip.
- Roll down or compress foam eartips before inserting. Hold the eartip in place for about 5 seconds while the foam expands to create a tight seal in the ear canal.

Earphone Removal

Remove earphones *slowly* with a twisting motion to gradually break the seal. Do not pull on the cable to remove the earphones.

4

Cleaning the Eartips

1. Remove the eartip.
2. Clean with water and mild soap.
3. Dry the eartip.
4. Replace the eartip.

Proper Care

- Do not expose the earphones to extreme temperatures.
- Avoid dropping and strong impact.
- Leave eartips on the earphones for shock protection.
- Do not pull on the cord to remove the headset from the device or the ear.
- Clean or replace flanged eartips prior to use by others.
- Replace disposable foam eartips regularly.
- Clean or replace flanged eartips every 6-12 months

5