

Warranty

Etymotic will repair or replace the defective product at its option if returned within one year of purchase to our designated service facility. This warranty is in lieu of all other warranties, expressed or implied, including, but not limited to, any implied warranty of merchantability or fitness for a particular purpose.

ETYMÖTIC RESEARCH INC.

61 Martin Lane • Elk Grove Village, IL 60007

www.etymotic.com • 1-888-389-6684 • 847-228-0006

©2010. BlastPLG and Musicians Earplugs are trademarks of Etymotic Research, Inc.

ER098519

EB15

High-Fidelity Electronic BlastPLG™ Earplugs



User Manual

Introduction

The High-Fidelity Electronic BlastPLG™ Earplug was developed by Etymotic Research to mitigate hearing damage and tinnitus sustained by an alarmingly high percentage of deployed soldiers. Despite risks to hearing from loud machinery and blasts, most warriors decline to wear hearing protection because they find it interferes with situational awareness.

There are two versions of BlastPLG Earplug, the EB1 and the EB15. Both versions are designed to restore sound that is blocked when the ear canal is sealed. Both allow you to hear naturally, as though there were nothing in the ear, and both prevent ear damage from loud impulse noise.

EB1 is a good choice for hunters who want to hear naturally and be protected from sudden firearm blasts when there isn't time to insert hearing protection. Increased loudness can be selected which boosts the faint sounds of speech and improves hearing at a distance. Additional clarity is built in for high-pitched sounds which are most difficult to hear.

EB15 is for persons who operate some or most of the time around continuous loud noise such as machinery, trucks, or construction equipment and want both blast protection and natural hearing when no background noise is present.

Both versions use a new adaptation of the original high-fidelity K-AMP® integrated circuit. The EB1 permits natural hearing until a blast occurs. EB1 has a switch to boost faint sounds if desired. EB15 circuitry is configured to protect the user in loud continuous noise from machinery and vehicles and from unexpected impulse noise such as gunfire and explosions. When no loud noise is present, the EB15 returns to natural hearing, as if nothing is in the ear to block sound. The EB15 also has a switch to boost faint sounds.

With practice, most users should experience normal situational awareness: Normal detection and normal ability to determine where a sound is located.

Etymotic Research Inc.

For over 25 years, Etymotic Research has designed innovative products to measure, enhance and protect hearing. Etymotic has contributed many of the major breakthroughs in hearing devices and consumer products available today, including advanced hearing aid circuitry, directional microphones and Musicians Earplugs™. Etymotic is the original inventor of noise-isolating in-ear earphones.

Precautions

- The EB15 is made from materials and components that are standard in hearing aids and hearing protection devices.
- Allergic reactions are uncommon. If redness, soreness or other adverse reactions occur, discontinue use and contact a medical practitioner.
- Do not shower or swim while wearing the device.
- Do not put batteries in your mouth.
- Batteries may be harmful if swallowed.
- Keep batteries out of the reach of children.

Identification

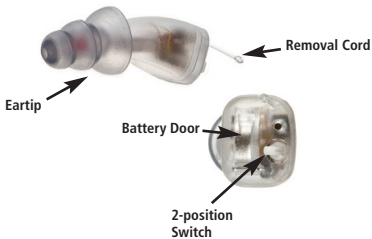

Headband



Filter tool and extra filters



Pouch



Cleaning Tool



312 Batteries

Battery Insertion

1. Remove the tab on the battery before inserting it in the EB15.
2. The battery door will not close if the battery is not inserted correctly.

Low Battery Warning

The EB15 has an audible low battery warning that alerts you when the battery is about to die. The signal starts as a slow ticking sound that becomes louder, faster and higher in pitch as the battery nears its end of life. EB15 performance is not altered when the warning is heard.

Eartips

Eartips



Lg. 3-flange

Sm. 3-flange

Foam

Glider

Sm. Foam

Selecting an eartip:

The eartip that is most comfortable is the likely choice but it **MUST SEAL** well. If you can easily hear others with the device turned off (battery door open) you don't have a good seal. Twist it in deeper, or choose another eartip.

When changing eartips make sure the eartip fits securely on the stem of the EB15.



correct

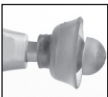

incorrect

Insertion & Removal

Inserting the EB15

- Pull the ear up and out while inserting.
- *Twist* and push gently until the eartip seals in the ear canal.
- When first using one of the 3-flange eartips, moistening slightly may ease insertion.



Removing the EB15

- Remove the device with a slow twisting motion.

Wind Noise

The EB15 includes a headband to wear over the earplugs if wind noise interferes with performance.

Operation

ON/OFF

The EB15 turns on and off by opening and closing the battery door. **Note:** It is not necessary to remove the battery as long as the door is open wide enough to disable the circuit.

Battery Door

Open = OFF
Closed = ON



2-position Switch

Toward battery door = LO position
Away from battery door = HI position

Switch

LO position: Automatic 3-stage action

- Natural hearing for faint and loud sounds
- Automatic high-fidelity 15 dB sound reduction for continuous loud noise
- Maximum protection from blasts

HI position: Automatic 3-stage action

- 15-dB boost for faint sounds
- Natural hearing for loud sounds
- Maximum protection from blasts

Changing Filters

The BlastPLG Earplug has a special filter that enhances sound quality and prevents earwax from entering the device. A filter should be changed if the volume decreases or the sound quality declines.

Filter Removal **Note: Use the tool to remove the filter.**



1. Remove Eartip.

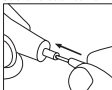

2. Insert tool into the filter.

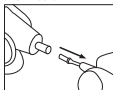

3. Remove filter.

Filter Replacement **Note: Do not use the tool to replace the filter.**



1. Insert a new filter and press gently against a hard surface to secure it in place.



2. Re-attach eartip.

Trouble Shooting

Problem: No sound

What to do:

- Check to see if the battery door is closed (EB15 turned on).
- Check battery; replace if dead.
- Clean the eartip and the end of the EB15.
- Check the filter
 - remove the filter
 - listen for sound to return before replacing the filter
- If sound returns replace the filter.

Care

Simple cleaning with the tool provided will keep the eartip clean and the EB15 working properly.

- Use the cleaning tool to pick out or brush off debris.
- The 3-flange eartip can be removed and cleaned in mild detergent. Dry the eartip thoroughly before reattaching it.
- Foam and glider eartips should be replaced as needed. They are not reusable.
- Do not use alcohol to clean the device.
- Remove the device before using hair products.
- Do not expose to extreme heat or moisture.
- Avoid dropping or hitting the device on a hard surface.



Cleaning Tool

Specifications

EB15 Switch: LO

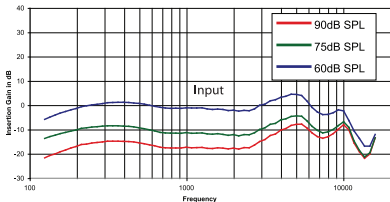

Switch: LO



Switch in the LO position:

- Natural hearing
- Protection from continuous loud noise
- Maximum blast protection

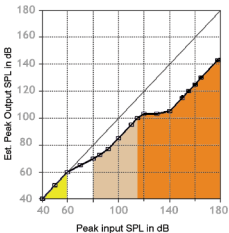

Specifications

EB15 Switch: HI

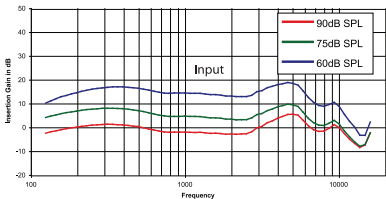

Switch: HI



- Switch in HI position:
- Boost for faint sounds
 - Natural hearing
 - Maximum blast protection

